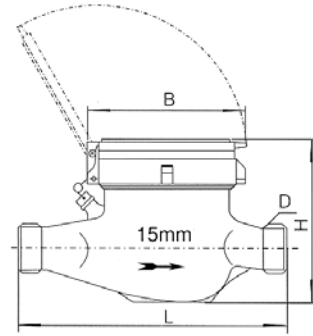

LIQUID SEALED VANE WHEEL WATER METER
MODEL: LXS-15F~20F

APPLICATION:

Measuring the volume of cold potable water passing through the pipeline.

FEATURES:

- Its digital wheels are sealed in the liquid-capsule and kept legible for reading.
- Available with non-return valve, inlet strainer and pulse output on request.

- High quality material applied to guarantee its function efficient and durable.
- The accuracy excels Class B stated in ISO 4064. Class C available for DN 15mm and DN 20mm

WORKING CONDITION:

 Water temperature: $\leq 40^{\circ}\text{C}$

 Water pressure: $\leq 1.6\text{Mpa}$
MAXIMUM PERMISSIBLE ERROR:
 $Q_{\min} \rightarrow Q_t (\text{ex } Q_t) = \pm 5\%$;

 $Q_t \rightarrow Q_s (\text{both included}) = \pm 2\%$ or $\pm 3\%$ (hot water)

 $Q_{\min} = \text{Min Flow}$, $Q_t = \text{Transition Flow}$, $Q_s = \text{Max Flow}$.

NOTE: only diameter 15mm and 20 can reach class C.
MAIN TECHNICAL DATA

Type	Size (mm)	Class	Q_s	Q_p	Q_t	Q_{\min}	Min. Reading	Max. Reading
			Max. Flow	Nominal Flow	Transitional Flow	Min. Flow		
			m^3/h		L/h		m^3	
LXS-15F	15	C	3	1.5	22.5	15	0.0001	99999
LXS-20F	20	B	5	2.5	200	50	0.0001	99999

DIMENSIONS AND WEIGHT

Type	Size	Length	Width	Height	Connecting Thread D	Weight kg
	mm					
LXS-15F	15	115/165	90	115	G 3/4B	1.2
LXS-20F	20	190	90	117	G 1B	1.7

GOLDLAND WATER PROJECT EQUIPMENT CO., LTD.
Address: No.8 Chenghu road Pingnan Guangxi China.

Tel: +86-775-7838101 Fax: +86-775-7838101 Postal code: 537300

 Web: <http://www.watermeter.hk> Email: info2@watermeter.hk

Note:

Both Class B and Class C is available. But Class C is popularly used for DN 15mm.

ACCESSORIES

one meter with 2 pcs tubes, 2 pcs nuts and 2 pcs gaskets for coupling.

FLOW ERROR CURVE

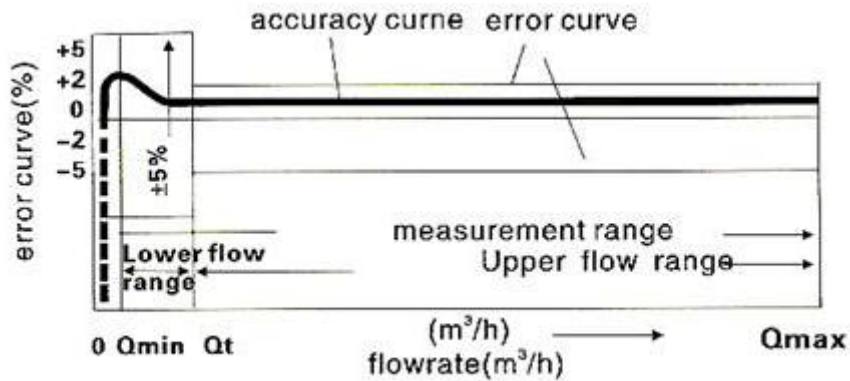

PRESSURE LOSS CURVE

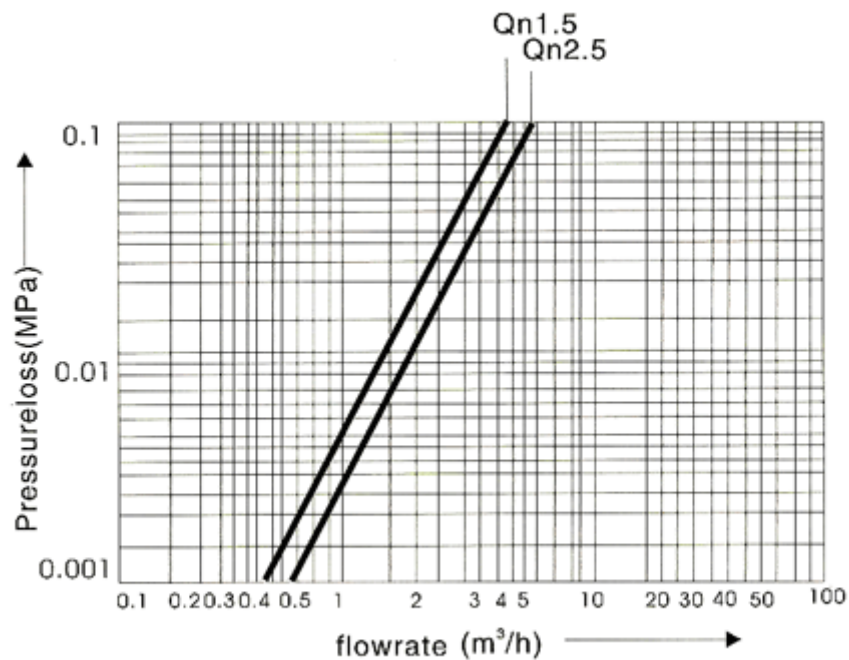

Installation Instruction-----domestic water meter

- Location for water meter must be accessible and far away from fog and humidity.
- This type water meter is horizontally installed only; verticality or slant installation is rejected. The arrow branded in the meter must correspond with the flow direction in the pipeline.
- Thoroughly flush remainder/debris in the pipe before connecting water meter with pipeline.
- For more accuracy the pipeline downstream the meter is recommended to elevate 500mm higher than the water meter level. (Illustrated below).

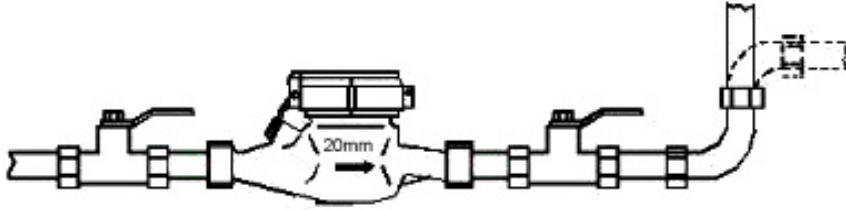

- If the meter services for a boiler, it is required to install a non-return valve at outlet of the meter.
- The indicated QN & pressure , maximum temperature 100°C for hot water meter, 50°C for cold water meter, can not be exceeded.
- Cleanse the strainer once every 3 years or so. Meanwhile retest the meter before re-installation. Generally the job should be done by the water supply administration department.

EXPLODED VIEW

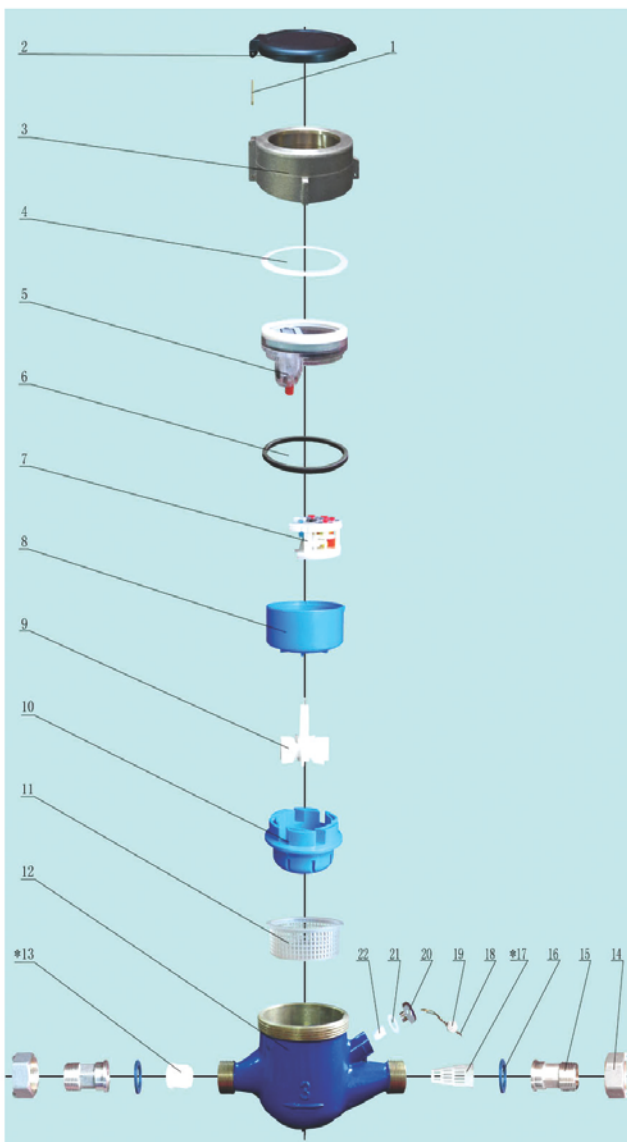

No.	Name	QTY	Material
1	Hinge pin	1	Brass
2	Lid	1	ABS
3	Brass Ring	1	ZHPb59-1
4	Gasket	1	HDPE
5	Seal register Assembly	1	subassembly
6	O-ring	1	Rubber
7	Register Gear:	1	
8	Register box	1	ABS
9	Vane Wheel Assembly	1	POM
10	Vane Wheel Chamber	1	ABS
11	Strainer	1	LDHE
12	Brass Body	1	ZHPb59-1
13	Check valve	1	ABS
14	Coupling nut	2	Brass
15	Coupling tail piece	2	Brass
16	Coupling Gasket	2	Rubber
17	Inlet strainer	1	PP
18	Wire	1	Brass
19	Seal Lead	1	Pb T3
20	Adjusting Plug	1	Brass
21	Adjusting Gasket	1	Nylon
22	Adjusting screw	1	POM