

VOLUMETRIC ROTARY PISTON PLASTIC BODY COLD WATER METER

MODEL: LXH-15-20

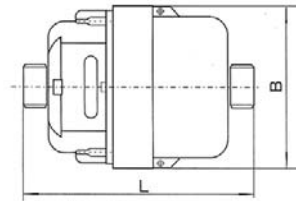

APPLICATION:

- ◆ Measuring the volume of cold potable water passing through the pipeline.

FEATURES:

- ◆ Completely plastic shell, solid and robust design, long service guaranteed.
- ◆ High quality materials fiberglass reinforced polymerization amine (UL NO.: E154352: SGS Report NO.: CE/2006/34019), corrosion resistance.
- ◆ Pole ring magnet polymer coating as protection against deposits.
- ◆ Plastic thread connecting fitting.
- ◆ Optimum accuracy and performance at all times, in any position;

- ◆ Revolutionary grooved piston for improved, durability and performance;
- ◆ Durable tamperproof construction;
- ◆ Volumetric meter, on principle of piston rotation, accurate measurement, easy and long term clear reading, etc.
- ◆ Measuring accuracy is up to ISO4064 C.

WORKING CONDITION:

- ◆ Water temperature: $\leq 40^{\circ}\text{C}$
- ◆ Water pressure: $\leq 1\text{MPa}$ or 1.6MPa optional (10bar or 16bar optional)

MAXIMUM PERMISSIBLE ERROR:

- ◆ In the lower zone from q_{\min} inclusive up to but excluding q_t is $\pm 5\%$
- ◆ In the upper zone from q_t inclusive up to and including q_s is $\pm 2\%$

ACCESSORIES

one meter with 2 pcs tubes, 2 pcs nuts and 2 pcs gaskets for coupling.

MAIN TECHNICAL DATA

Type	Size (mm)	Class	q_s	q_p	q_t	q_{\min}	Min. Reading	Max. Reading
			Max. Flow	Nominal Flow	Transitional Flow	Min. Flow		
			m ³ /h		L/h		m ³	
LXH-15	15	C	3	1.5	22.5	15	0.0001	9999
LXH-20	20	C	5	2.5	37.5	25	0.0001	9999

DIMENSIONS AND WEIGHT

Type	Size	Length	Width	Height	Connecting Thread D	Weight kg
LXH-15	15	115	110	100	G3/4B	0.5
LXH-20	20	130	110	100	G1B	0.65

FLOW ERROR CURVE

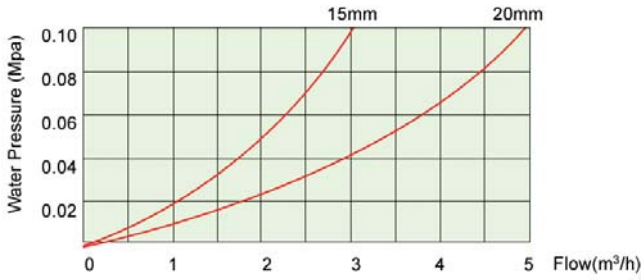

PRESSURE LOSS CURVE

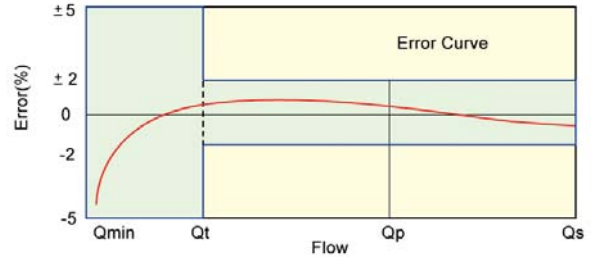

PULSE TRANSMITTING WATER METER APPLICATION AND FEATURES

- ◆ Applied for remote automatic reading system.
- ◆ Meter with pulse output: Available 1L, 10L, 100L or 1000L per pulse for choice.
- ◆ Water meter equipped with a Reed Switch Pulser which can be connected to remote reading systems. The Reed Switch Pulser emits signal to collector, a single signal means a certain quantity of water.
- ◆ Different option of water quantity per pulse is alternative and data refers to the mentioned table format below.

REED-SWITCH ELECTRIC DATA

Switch voltage: 24VAC/ DC

Switch current: 0.01A max

OUTPUT DATA:

Size	Pulse output			
	1L/Pulse	10L/Pulse	100L/Pulse	1000L/Pulse
15mm	√	√	√	√
20mm	√	√	√	√

LXHY-15-20

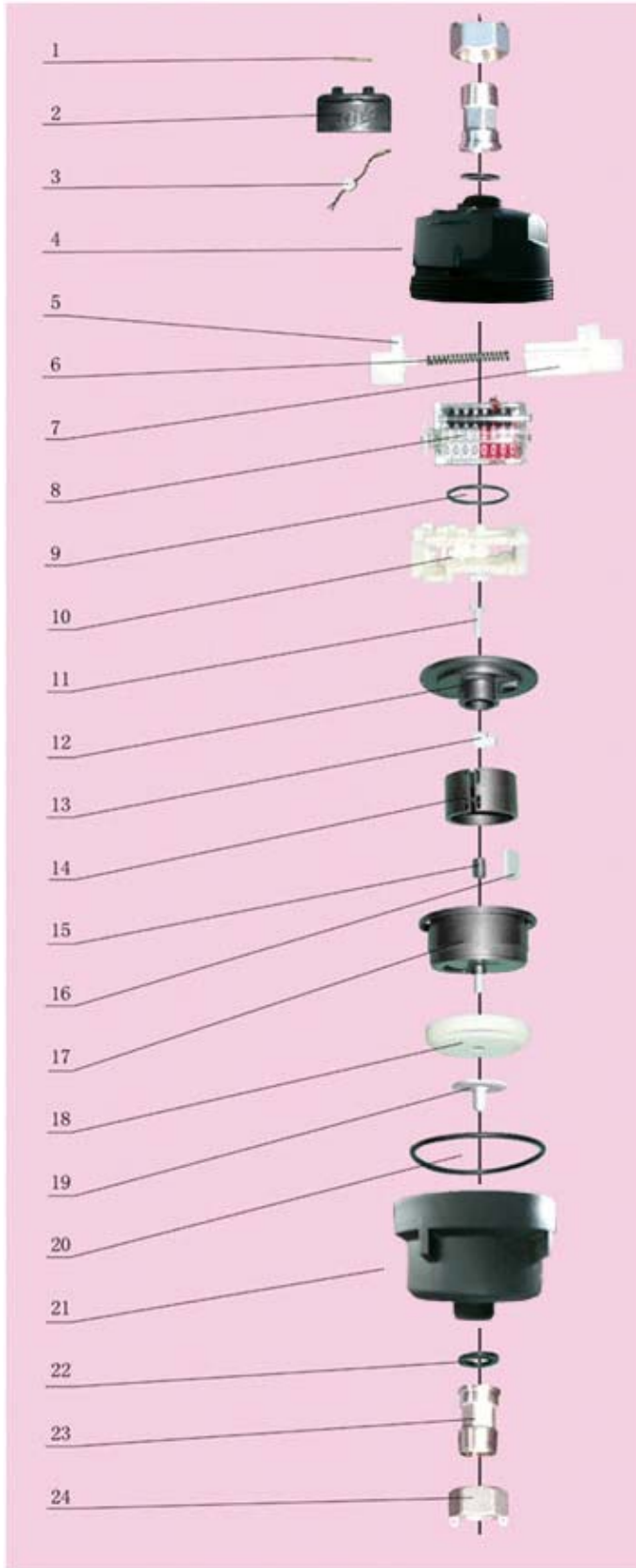

EXPLODED VIEW LXH-15-20

No.	Name	QTY	Material
1	Hinge pin	1	H62
2	Lid	1	ABS
3	Seal lead	1	T3 , Pb
4	Top cover	1	HPb59-1
5	Moveable clamp	1	POM
6	Spring	1	1Cr18Ni9
7	Clamp	1	POM
8	Register	1	Subassembly
9	O-ring	1	Rubber
10	Decelerate device	1	Subassembly
11	Transmission shaft	1	POM
12	Seal plate	1	Subassembly
13	Dial fork	1	POM
14	Piston	1	Polystyrene
15	Bush	1	Nylon
16	Flashboard	1	POM
17	Register body	1	Subassembly
18	Strainer	1	ABS
19	Non return valve	1	Subassembly
20	O-ring	1	Rubber
21	Lower cover	1	HPb59-1
22	Joint washer	2	Rubber
23	Coupling	2	Plastic
24	Coupling nut	2	Plastic